



High Current SMD Power Inductors - SEP3012ET SERIES



PART NUMBERING SYSTEM

| | | | | | |
|------------|---------------|---|-------------|---|-----------|
| SEP | 3012ET | — | R47N | — | LF |
| TYPE | DIMENSIONS | | INDUCTANCE | | LEAD FREE |

FEATURES :

- Magnetically High Current Power Inductors .
- Low profile (1.2mm max. height) and 3.2 mm max. square compact original design .
- Low acoustic noise and low leakage flux noise by shielded construction .
- Halogen Free , 100% lead (Pb) Free and RoHS compliant .

SHAPES AND DIMENSIONS :

UNIT : mm

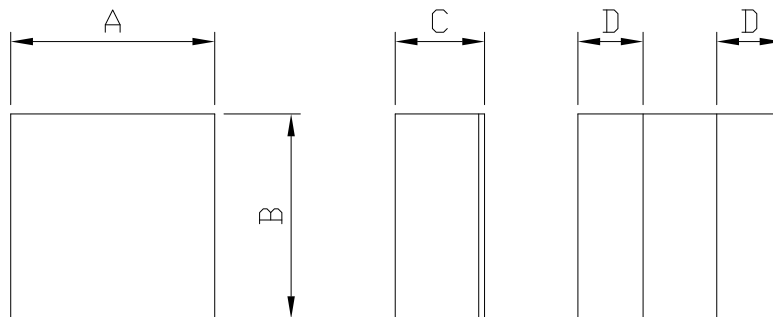

A=3.0±0.2 B=3.0±0.2 C=1.2 Max. D=1.2 Max.

RECOMMENDED PATTERNS

UNIT : mm

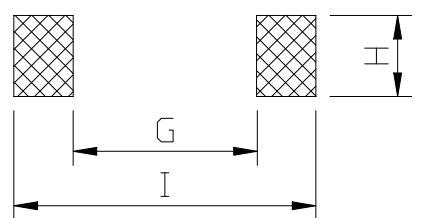

H=3.4 G= 0.8 I = 3.4

High Current SMD Power Inductors - SEP3012ET SERIES



SPECIFICATION TABLE

| PART NUMBER | INDUCTANCE (μH) | Isat (A) (Max.) | Irms (A) (Typ.) | DCR (mΩ) (Max.) | TEST FREQ. (Freq.) |
|-------------------|-----------------|-------------------|-------------------|-----------------|----------------------|
| SEP3012ET-R33N-LF | 0.33±30% | 11.1 | 3.40 | 22.8 | 100KHz/1V |
| SEP3012ET-R47N-LF | 0.47±30% | 9.40 | 3.20 | 26.4 | 100KHz/1V |
| SEP3012ET-R56N-LF | 0.56±30% | 8.50 | 3.00 | 34.8 | 100KHz/1V |
| SEP3012ET-R68N-LF | 0.68±30% | 7.70 | 2.70 | 43.2 | 100KHz/1V |
| SEP3012ET-1R0M-LF | 1.0±20% | 5.20 | 2.50 | 51.0 | 100KHz/1V |
| SEP3012ET-1R2M-LF | 1.2±20% | 5.00 | 2.30 | 66.0 | 100KHz/1V |
| SEP3012ET-1R5M-LF | 1.5±20% | 4.70 | 1.90 | 96.0 | 100KHz/1V |
| SEP3012ET-2R2M-LF | 2.2±20% | 4.60 | 1.70 | 115 | 100KHz/1V |
| SEP3012ET-3R3M-LF | 3.3±20% | 3.70 | 1.30 | 180 | 100KHz/1V |
| SEP3012ET-4R7M-LF | 4.7±20% | 3.30 | 1.00 | 308 | 100KHz/1V |
| SEP3012ET-5R6M-LF | 5.6±20% | 3.00 | 0.90 | 389 | 100KHz/1V |
| SEP3012ET-6R8M-LF | 6.8±20% | 2.40 | 0.80 | 424 | 100KHz/1V |

- Isat : DC current at which the inductance drops 20% (typ) from its value without current.
- I rms : Average current for a 40°C temperature rise above 25°C ambient.
- Operating temperature range -40°C to +120°C , Electrical specifications at 25°C .

PACKAGING SPECIFICATION

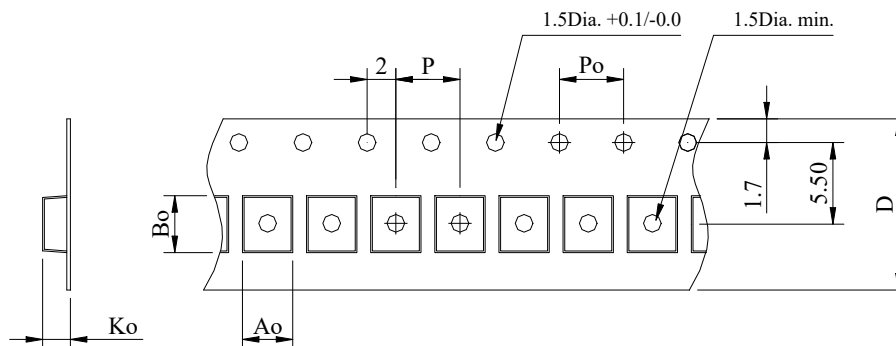

| STAYLE | Q' TY (PCS) | DIMENSIONS (m/m) | | | | | |
|--------|-------------|------------------|---------|---------|-------|---------|--------|
| | | Ao | Bo | Ko | P | Po | D |
| 7" | 1,000 | 3.5±0.1 | 3.5±0.1 | 1.4±0.1 | 8±0.1 | 4.0±0.1 | 12±0.3 |